

State of Illinois, Ogle County

Administrative Citation

RECEIVED

CLERK'S OFFICE

NOV 25 2003

STATE OF ILLINOIS
Pollution Control Board

| | | |
|------------------|---|--------------------------------|
| Ogle County |) | #1418005001 - Gilland, Kenneth |
| |) | Ogle County |
| Complainant |) | |
| |) | |
| v. |) | |
| |) | |
| Gilland, Kenneth |) | |
| |) | |
| Respondent |) | |

AC 04-24

Jurisdiction

This Administrative Citation is issued pursuant to authority vested in the Illinois Environmental Protection Agency by 415 ILCS 5/31.1 (1996) and delegated to Ogle County pursuant to 415 ILCS 5/4(r).

Facts

1. That Respondent, Kenneth Gilland, is the present operator of a facility located in the County of Ogle, State of Illinois.
2. That said facility is an open dump operating without an Illinois Environmental Protection Agency Operating Permit, and designated with Site Code No. 1418005001.
3. That Respondent has owned and/or operated said facility at all times pertinent hereto.
4. That on August 15, 2003, Joy K. Bliton, Field Inspector for the Ogle County Solid Waste Management Department, under the authority of the Illinois Environmental Protection Agency, inspected the above described facility. A copy of the inspection report setting forth the results of such inspection is attached hereto and made a part hereof.

Violations

On the basis of direct observation, Joy Bliton, Field Inspector, of the Ogle County Solid Waste Management Department, has determined that the Respondent has caused or allowed open dumping at the above-described facility in a manner which resulted in the following occurrences:

- A. That on August 15, 2003, and September 24, 2003, an on-site inspection of said facility disclosed the following:
- (1) The Respondent has caused or allowed litter in violation of 415 ILCS 5/21(p)(1) (1996).
 - (2) The Respondent has caused or allowed open burning in violation of 415 ILCS 5/21(p)(3) (1996).
 - (3) The Respondent has caused or allowed the deposition of general construction or demolition debris as defined in Section 3.78 of the Environmental Protection Act in violation of 415 ILCS 5/21(p)(7). (1996).

Civil Penalty

Pursuant to 415 ILCS 5/42(b)(4) (1996), Respondent herein is subject to a civil penalty of Fifteen Hundred Dollars (\$1500.00) for each violation specified above in Paragraph A, for a total of \$4,500 Penalty, four thousand, five hundred dollars. Additionally, should Respondent elect to petition the Illinois Pollution Control Board under the review process described herein below, and if there is a finding of the violations alleged herein, after an adjudicatory hearing, Respondent shall be assessed the associated hearing costs incurred by the Illinois Environmental Protection Agency and the Illinois Pollution Control Board, in addition to the Fifteen Hundred Dollar (\$1500.00) statutory penalty for each finding of violation.

If you acknowledge the violations cited hereinabove, the civil penalty specified above shall be due and payable no later than thirty-five (35) days from the date of service hereof. If you do not petition the Illinois Pollution Control Board for review of this Administrative Citation within thirty-five (35) days of service hereof or if you elect to contest this Administrative Citation, any judgment rendered against you shall specify the due date of the statutory civil penalty and any costs assessed against you.

Your check should be made payable to the Ogle County Treasurer's Office and mailed to the attention of John Coffman, Ogle County Treasurer, Ogle County Courthouse, Oregon, IL 61061. Also, please complete and return the enclosed remittance form, along with your payment, to assure proper credit.

If any civil penalty imposed by the Illinois Pollution Control Board is not paid within the time prescribed in the order, interest on such penalty will be assessed for the period from the date payment is due until the date payment is received. If any civil penalty, by reason of acknowledgment, default or finding after adjudicatory hearing is not paid when due, the Ogle County State's Attorney shall be requested to initiate proceedings in Circuit Court to collect said civil penalty. In addition to the previously assessed civil penalty, interest, and hearing costs of Ogle County and the Illinois Pollution Control Board, if any, the Ogle County State's Attorney will seek to recover their costs of litigation.

Procedure for Contesting this Administrative Citation

You have the right to contest this Administrative Citation. See 415 ILCS 5/31.1 (1996). If you elect to contest this Administrative Citation, you must file a Petition for Review with the Clerk of the Illinois Pollution Control board. A copy of the Petition for Review should be filed

with the Ogle County State's Attorney. Such Petition for Review must be filed within thirty-five (35) days of the date of service of this Administrative Citation, or a default judgment shall be entered by the Pollution Control Board. The Petition for Review may be filed with the Clerk of the Illinois Pollution Control Board at the State of Illinois Center, 100 West Randolph, Suite 11-500, Chicago, Illinois 60601; and, a copy of said Petition for Review filed with the Ogle County State's Attorney at the Ogle County Courthouse, Oregon, Illinois 61061.

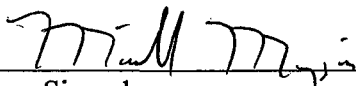

Signed

19 November 2007

Date

Certified Mail: 7000 1670 0013 0425 8066

Enclosure

C: Regional File
 Division File
 Compliance File
 Ogle County State's Attorney

Attachment A

Warning: Corrective Action Required

To contest the Administrative Citation you must follow the instructions provided in the Administrative Citation. You may be served with additional Administrative Citations if you fail to complete the following corrective actions, and are found to be in violation of Section 21(p) of the Illinois Environmental Protection Act. Additional inspection(s) will be conducted to verify cleanup and compliance.

You must complete the following corrective actions:

1. Immediately cease all open dumping and open burning.
2. By January 2, 2004, remove all waste to a permitted landfill or transfer station. Scrap metal not disposed of at a landfill can be taken to a scrap metal facility or recycling center.
3. By January 5, 2004, submit to the Ogle County Solid Waste Management Department copies of receipts that document the proper disposal or recycling of the wastes.

Remittance Form

| | | |
|------------------|---|--------------------------------|
| Ogle County |) | #1418005001 - Gilland, Kenneth |
| |) | Ogle County |
| Complainant |) | |
| |) | |
| v. |) | |
| |) | |
| Gilland, Kenneth |) | |
| |) | |
| Respondent |) | |

Facility: Gilland, Kenneth

County: Ogle County

Date of Inspection(s): August 15, 2003 and September 24, 2003

Site Code: 1418005001

Civil Penalty: \$4500

Date Remitted: _____

SS/FEIN# _____

Signature _____

Note:

Please include information on the blank lines. Mail this form with your check to:

John Coffman, Ogle County Treasurer
Ogle County Courthouse
Oregon, IL 61061

ILLINOIS ENVIRONMENTAL PROTECTION AGENCY
Open Dump Inspection Checklist

County: Ogle LPC#: 1418005001 Region: 1 - Rockford
 Location/Site Name: Gilland, Kenneth
 Date: 09/24/2003 Time: From 12:50 To 1:00 pm Previous Inspection Date: 08/15/2003
 Inspector(s): J. Bliton and M. Miller, Zoning Dept. Weather: Partly Cloudy
 No. of Photos Taken: # 6 Est. Amt. of Waste: 50 yds³ Samples Taken: Yes # No ☒
 Interviewed: Ken Gilland Complaint #: 2177

Responsible Party
 Mailing Address(es)
 and Phone
 Number(s):

Kenneth Gilland
 P. O. Box 491
 Milledgeville, IL 61051

| | SECTION | DESCRIPTION | VIOL |
|---|---------|--|-------------------------------------|
| ILLINOIS ENVIRONMENTAL PROTECTION ACT REQUIREMENTS | | | |
| 1. | 9(a) | CAUSE, THREATEN OR ALLOW AIR POLLUTION IN ILLINOIS | <input checked="" type="checkbox"/> |
| 2. | 9(c) | CAUSE OR ALLOW OPEN BURNING | <input checked="" type="checkbox"/> |
| 3. | 12(a) | CAUSE, THREATEN OR ALLOW WATER POLLUTION IN ILLINOIS | <input type="checkbox"/> |
| 4. | 12(d) | CREATE A WATER POLLUTION HAZARD | <input checked="" type="checkbox"/> |
| 5. | 21(a) | CAUSE OR ALLOW OPEN DUMPING | <input checked="" type="checkbox"/> |
| 6. | 21(d) | CONDUCT ANY WASTE-STORAGE, WASTE-TREATMENT, OR WASTE- DISPOSAL OPERATION: | |
| | (1) | Without a Permit | <input checked="" type="checkbox"/> |
| | (2) | In Violation of Any Regulations or Standards Adopted by the Board | <input type="checkbox"/> |
| 7. | 21(e) | DISPOSE, TREAT, STORE, OR ABANDON ANY WASTE, OR TRANSPORT ANY WASTE INTO THE STATE AT/TO SITES NOT MEETING REQUIREMENTS OF ACT | <input type="checkbox"/> |
| 8. | 21(p) | CAUSE OR ALLOW THE OPEN DUMPING OF ANY WASTE IN A MANNER WHICH RESULTS IN ANY OF THE FOLLOWING OCCURRENCES AT THE DUMP SITE: | |
| | (1) | Litter | <input checked="" type="checkbox"/> |
| | (2) | Scavenging | <input type="checkbox"/> |
| | (3) | Open Burning | <input checked="" type="checkbox"/> |
| | (4) | Deposition of Waste in Standing or Flowing Waters | <input type="checkbox"/> |
| | (5) | Proliferation of Disease Vectors | <input type="checkbox"/> |
| | (6) | Standing or Flowing Liquid Discharge from the Dump Site | <input type="checkbox"/> |

LPC # 1418005001

Inspection Date: 09/24/03

| | | | |
|--|------------|---|-------------------------------------|
| | (7) | Deposition of General Construction or Demolition Debris; or Clean Construction or Demolition Debris | <input checked="" type="checkbox"/> |
| 9. | 55(a) | NO PERSON SHALL: | |
| | (1) | Cause or Allow Open Dumping of Any Used or Waste Tire | <input type="checkbox"/> |
| | (2) | Cause or Allow Open Burning of Any Used or Waste Tire | <input type="checkbox"/> |
| 35 ILLINOIS ADMINISTRATIVE CODE REQUIREMENTS SUBTITLE G | | | |
| 10. | 812.101(a) | FAILURE TO SUBMIT AN APPLICATION FOR A PERMIT TO DEVELOP AND OPERATE A LANDFILL | <input checked="" type="checkbox"/> |
| 11. | 722.111 | HAZARDOUS WASTE DETERMINATION | <input type="checkbox"/> |
| 12. | 808.121 | SPECIAL WASTE DETERMINATION | <input type="checkbox"/> |
| 13. | 809.302(a) | ACCEPTANCE OF SPECIAL WASTE FROM A WASTE TRANSPORTER WITHOUT A WASTE HAULING PERMIT, UNIFORM WASTE PROGRAM REGISTRATION AND PERMIT AND/OR MANIFEST | <input type="checkbox"/> |
| OTHER REQUIREMENTS | | | |
| 14. | | APPARENT VIOLATION OF: (<input type="checkbox"/>) PCB; (<input type="checkbox"/>) CIRCUIT COURT CASE NUMBER: ORDER ENTERED ON: | <input type="checkbox"/> |
| 15. | OTHER: | | <input type="checkbox"/> |
| | | | <input type="checkbox"/> |
| | | | <input type="checkbox"/> |
| | | | <input type="checkbox"/> |
| | | | <input type="checkbox"/> |
| | | | <input type="checkbox"/> |

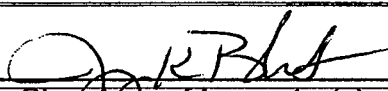
Signature of Inspector(s)

Informational Notes

1. [Illinois] Environmental Protection Act: 415 ILCS 5/4.
2. Illinois Pollution Control Board: 35 Ill. Adm. Code, Subtitle G.
3. Statutory and regulatory references herein are provided for convenience only and should not be construed as legal conclusions of the Agency or as limiting the Agency's statutory or regulatory powers. Requirements of some statutes and regulations cited are in summary format. Full text of requirements can be found in references listed in 1. and 2. above.
4. The provisions of subsection (p) of Section 21 of the [Illinois] Environmental Protection Act shall be enforceable either by administrative citation under Section 31.1 of the Act or by complaint under Section 31 of the Act.
5. This inspection was conducted in accordance with Sections 4(c) and 4(d) of the [Illinois] Environmental Protection Act: 415 ILCS 5/4(c) and (d).
6. Items marked with an "NE" were not evaluated at the time of this inspection.

STATE OF ILLINOIS
ENVIRONMENTAL PROTECTION AGENCY

NARRATIVE INSPECTION REPORT DOCUMENT

Date of Inspection: 09/24/03 Inspector: Joy Bliton/Steve Rypkema
Site Code: 1418005001 County: Ogle
Site Name: Gilland, Kenneth Time: 12:50 – 1:00 p.m.

GENERAL REMARKS

Weather conditions: Partly cloudy

This site had been brought to the attention of the Ogle County Health Department on August 14, 2000. At that time, there was a complaint regarding a vacant, half-burned house that was a hazard to neighborhood children. After an inspection the Ogle County Health Department asked Kenneth Gilland to demolish the house. K. Gilland said he thought the fire was being investigated by police so he had not yet demolished it. Sgt. Meyers of the Ogle County Sheriff's Department said there was no on-going investigation and the house could be demolished. K. Gilland was informed of Sgt. Meyers's comments on November 11, 2000 and Gilland replied that he will demolish the house at the end of November, 2000.

The Ogle County Solid Waste Management Department received a new complaint regarding this house on May 15, 2003. An inspection by J. Bliton on August 15, 2003 revealed a pile of demolition waste burning. J. Bliton told K. Gilland the fire would have to be put out and the waste would have to be taken to an IEPA permitted landfill. The old house had been demolished and was sitting in a big pile. J. Bliton explained the state laws regarding construction and demolition waste. She also explained that K. Gilland will either receive an Administrative Citation Warning Notice or an Administrative Citation which could result in a fine of \$4500.

An Administrative Citation Warning Notice was sent to K. Gilland on August 27, 2003, with a compliance deadline of September 15, 2003.

On September 24, 2003, Mark Miller of the Ogle County Planning and Zoning Department and Joy Bliton, reinspected the site. There has been no progress made in the cleanup of this site. It looks as it did on August 15, 2003. Photographs were taken. They left at 1:00 p.m.

State of Illinois
Environmental Protection Agency

SITE SKETCH FORM

Date of Inspection: 9-24-03 Inspector: JB
Site Code: 1418005001 County: Ogle County
Site Name: Gilland, Kenneth Time: 12:50 pm - 1:30 pm

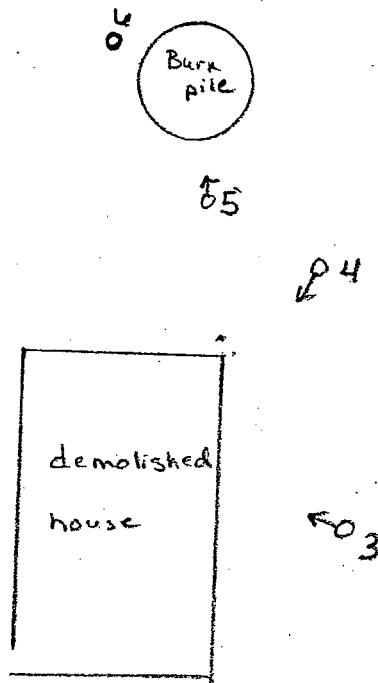

01,2
Young street



North

Not drawn to scale

Numbers denote
photo location &
direction

Digital Photograph Photocopies

Date: 09/24/03
Photos taken by: Joy Bliton

Site: #1418005001-Gilland, Kenneth
County: Ogle

Time: 12:55 p.m.

Direction: N

Photo File Name:
1418005001~092403~001

Comments:
Old house demolished.



Time: 12:56 p.m.

Direction: N

Photo File Name:
1418005001~092403~002

Comments:
Old house demolished. Has
not been cleaned up.



Digital Photograph Photocopies

Date: 09/24/03
Photos taken by: Joy Bliton

Site: #1418005001 - Gilland, Kenneth
County: Ogle

Time: 12:56 p.m.

Direction: NW

Photo File Name:
1418005001~092403~003

Comments:
Old house demolished, not
cleaned up.



Time: 12:59 p.m.

Direction: SW

Photo File Name:
1418005001~092403~004

Comments:
Pile of waste from old house.



Digital Photograph Photocopies

Date: 09/24/03
Photos taken by: Joy Bliton

Site: #1418005001-Gilland, Kenneth
County: Ogle

Time: 12:59 p.m.

Direction: N

Photo File Name:
1418005001~092403~005

Comments:
Old burn pile.



Time: 12:59 p.m.

Direction: Down

Photo File Name:
1418005001~092403~006

Comments:
Burn pile has not been
cleaned up.



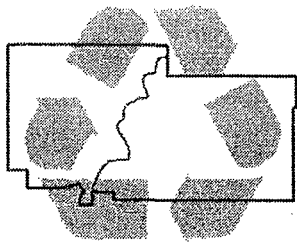

**OGLE COUNTY
SOLID WASTE MANAGEMENT DEPARTMENT**

105 S. Sixth Street
Oregon, IL 61061
815-732-4020
FAX: 815-732-3709
www.oglecounty.org

**OPEN DUMP ADMINISTRATIVE CITATION
WARNING NOTICE**

Ogle County Solid Waste
Management Department
Complainant

vs.

Gilland, Kenneth
Respondent

#1418005001 - Ogle
Gilland Kenneth
Compliance File

File Copy

WARNING: CORRECTIVE ACTION REQUIRED

You may be subject to substantial civil penalties if you fail to comply with the terms of this Administrative Citation Warning Notice, and are found to be in violation of the [Illinois] Environmental Protection Act.

FACTS

The purpose of this notice is to inform you of the results of an inspection by the Ogle County Solid Waste Management Department on August 15, 2003, and the corrective action required. This inspection was conducted to evaluate compliance with the requirements of Section 21(a) and Section 21(p) of the [Illinois] Environmental Protection Act. The alleged violations found during the inspection are identified in the attached inspection report.

**YOU MUST COMPLETE THE
FOLLOWING CORRECTIVE ACTIONS:**

- #1 Immediately cease all open dumping and open burning. Do not dispose of any of the waste by open burning or burial.**
- #2 By September 15, 2003, remove all waste to a permitted landfill or transfer station. Scrap metal not disposed at a landfill can be taken to a scrap metal facility or recycling center.**
- #3 By September 30, 2003 submit to the Ogle County Solid Waste Management Department copies of receipts that document the proper disposal or recycling of the wastes.**

REQUIRED RESPONSE

Within fifteen (15) calendar days of the date of this notice, you must submit in writing:

1. the reasons for the alleged violation(s),
2. a description of the corrective actions that have been or will be taken to correct the alleged violation(s), and
3. a proposal to ensure that the alleged violation(s) will not recur.

Your written response submitted in reply to this notice must be sent to:

Ogle County Solid Waste Management Department
Stephen J. Rypkema, Director
105 S. 5th Street
Oregon, IL 61061

On any correspondence you send concerning this matter, please reference the facility number and facility name listed on the first page of this Notice.

POTENTIAL SANCTIONS

For any violations of Section 21(p) of the [Illinois] Environmental Protection Act ("Act") [415 ILCS 5/21 (2000)] cited in the attached inspection report, the Ogle County Solid Waste Management Department may, without further notice and regardless of any future activities to achieve compliance, ~~file an Administrative Citation before the Illinois Pollution Control Board pursuant to Section 31.1~~ of the Act [415 ILCS 5/31.1 (2000)]. An Administrative Citation carries a fine of \$1,500.00 for a first offense and \$3,000 for a second or subsequent offense for violation of any provision of Section 21(p). **Even if the Ogle County Solid Waste Management Department files an Administrative Citation and/or other enforcement action, you are still required to remedy each and every violation identified in the attached inspection report.**

You are also advised that your noncompliance could result in the filing of an enforcement action pursuant to Title VIII and/or Title XII of the Act.

Ogle County Solid Waste Management Department personnel will conduct a reinspection to verify compliance.

Should you have any questions concerning the Administrative Citation Warning Notice or need further assistance, contact Ogle County Solid Waste Management Department.

Ogle County Solid Waste Management Department

By:

Stephen J. Rypkema, Director

Date: August 27, 2003

CERTIFIED MAIL #:7099 3220 0007 4798 3716

SJR/j

Enclosure

c: Regional File
Division File
Compliance File

cc: D. Ellis, S.A.

ILLINOIS ENVIRONMENTAL PROTECTION AGENCY

Open Dump Inspection Checklist

County: Ogle LPC#: 1418005001 Region: 1 - Rockford
 Location/Site Name: Gilland, Kenneth
 Date: 08/15/2003 Time: From 11:25 To 11:50 am Previous Inspection Date: _____
 Inspector(s): J. K. Bliton Weather: Partly sunny, 83 degrees, W. W 7 mph
 No. of Photos Taken: # 10 Est. Amt. of Waste: 50 yds³ Samples Taken: Yes # _____ No ☒
 Interviewed: Ken Gilland Complaint #: 2177

Responsible Party
 Mailing Address(es)
 and Phone
 Number(s):

Kenneth Gilland
 P. O. Box 491
 Milledgeville, IL 61051

| | SECTION | DESCRIPTION | VIOL |
|---|---------|--|-------------------------------------|
| ILLINOIS ENVIRONMENTAL PROTECTION ACT REQUIREMENTS | | | |
| 1. | 9(a) | CAUSE, THREATEN OR ALLOW AIR POLLUTION IN ILLINOIS | <input checked="" type="checkbox"/> |
| 2. | 9(c) | CAUSE OR ALLOW OPEN BURNING | <input checked="" type="checkbox"/> |
| 3. | 12(a) | CAUSE, THREATEN OR ALLOW WATER POLLUTION IN ILLINOIS | <input type="checkbox"/> |
| 4. | 12(d) | CREATE A WATER POLLUTION HAZARD | <input checked="" type="checkbox"/> |
| 5. | 21(a) | CAUSE OR ALLOW OPEN DUMPING | <input type="checkbox"/> |
| 6. | 21(d) | CONDUCT ANY WASTE-STORAGE, WASTE-TREATMENT, OR WASTE- DISPOSAL OPERATION: | |
| | (1) | Without a Permit | <input checked="" type="checkbox"/> |
| | (2) | In Violation of Any Regulations or Standards Adopted by the Board | <input type="checkbox"/> |
| 7. | 21(e) | DISPOSE, TREAT, STORE, OR ABANDON ANY WASTE, OR TRANSPORT ANY WASTE INTO THE STATE AT/TO SITES NOT MEETING REQUIREMENTS OF ACT | <input type="checkbox"/> |
| 8. | 21(p) | CAUSE OR ALLOW THE OPEN DUMPING OF ANY WASTE IN A MANNER WHICH RESULTS IN ANY OF THE FOLLOWING OCCURRENCES AT THE DUMP SITE: | |
| | (1) | Litter | <input checked="" type="checkbox"/> |
| | (2) | Scavenging | <input type="checkbox"/> |
| | (3) | Open Burning | <input checked="" type="checkbox"/> |
| | (4) | Deposition of Waste in Standing or Flowing Waters | <input type="checkbox"/> |
| | (5) | Proliferation of Disease Vectors | <input type="checkbox"/> |
| | (6) | Standing or Flowing Liquid Discharge from the Dump Site | <input type="checkbox"/> |

LPC # 1418005001

Inspection Date: 08/15/03

| | | | |
|--|------------|--|-------------------------------------|
| | (7) | Deposition of General Construction or Demolition Debris; or Clean Construction or Demolition Debris | <input checked="" type="checkbox"/> |
| 9. | 55(a) | NO PERSON SHALL: | |
| | (1) | Cause or Allow Open Dumping of Any Used or Waste Tire | <input type="checkbox"/> |
| | (2) | Cause or Allow Open Burning of Any Used or Waste Tire | <input type="checkbox"/> |
| 35 ILLINOIS ADMINISTRATIVE CODE REQUIREMENTS SUBTITLE G | | | |
| 10. | 812.101(a) | FAILURE TO SUBMIT AN APPLICATION FOR A PERMIT TO DEVELOP AND OPERATE A LANDFILL | <input type="checkbox"/> |
| 11. | 722.111 | HAZARDOUS WASTE DETERMINATION | <input type="checkbox"/> |
| 12. | 808.121 | SPECIAL WASTE DETERMINATION | <input type="checkbox"/> |
| 13. | 809.302(a) | ACCEPTANCE OF SPECIAL WASTE FROM A WASTE TRANSPORTER WITHOUT A WASTE HAULING PERMIT, UNIFORM WASTE PROGRAM REGISTRATION AND PERMIT AND/OR MANIFEST | <input type="checkbox"/> |
| OTHER REQUIREMENTS | | | |
| 14. | | APPARENT VIOLATION OF: <input type="checkbox"/> PCB; <input type="checkbox"/> CIRCUIT COURT CASE NUMBER: ORDER ENTERED ON: | <input type="checkbox"/> |
| 15. | OTHER: | | <input type="checkbox"/> |
| | | | <input type="checkbox"/> |
| | | | <input type="checkbox"/> |
| | | | <input type="checkbox"/> |
| | | | <input type="checkbox"/> |
| | | | <input type="checkbox"/> |

Signature of Inspector(s)

Informational Notes

1. [Illinois] Environmental Protection Act: 415 ILCS 5/4.
2. Illinois Pollution Control Board: 35 Ill. Adm. Code, Subtitle G.
3. Statutory and regulatory references herein are provided for convenience only and should not be construed as legal conclusions of the Agency or as limiting the Agency's statutory or regulatory powers. Requirements of some statutes and regulations cited are in summary format. Full text of requirements can be found in references listed in 1. and 2. above.
4. The provisions of subsection (p) of Section 21 of the [Illinois] Environmental Protection Act shall be enforceable either by administrative citation under Section 31.1 of the Act or by complaint under Section 31 of the Act.
5. This inspection was conducted in accordance with Sections 4(c) and 4(d) of the [Illinois] Environmental Protection Act: 415 ILCS 5/4(c) and (d).
6. Items marked with an "NE" were not evaluated at the time of this inspection.

STATE OF ILLINOIS
ENVIRONMENTAL PROTECTION AGENCY

NARRATIVE INSPECTION REPORT DOCUMENT

Date of Inspection: 08/15/03 Inspector: Joy Bliton/Steve Rypkema
Site Code: 1418005001 County: Ogle
Site Name: Gilland, Kenneth Time: 11:25 – 11:50 a.m.

GENERAL REMARKS

Weather conditions: 83 degrees, partly sunny, winds W 7 mph.

8/15/03 - I arrived at the site at 11:25 a.m. Ken Gilland was on a skid loader and another man was working on the tire. I identified myself and we spoke about the burn pile which was still smoldering. In the pile was roofing material, slate siding, lumber, metal, old plaster, flashing, asphalt siding, etc. The pile was demolition waste from the house.

Mr. Gilland said that he was just burning lumber. I explained that lumber is not legal to burn either. I explained that landscape waste would have been o.k. to burn. He said some people burn here when he is gone. He accepted a "No Burning" sign that he put up.

I told him that the fire, which was still smoldering, had to be put out. He said he would after they fix the wheel. I told him the demolition waste would have to be taken to an IEPA permitted landfill and copies of the receipts would have to be sent to me. I explained this will either result in an ACWN or an AC which could result in a fine of \$4,500. He understood.

I left there at 11:50 a.m. (JKB)

8/26/03 – Steve Rypkema reinspected. It appears that the site has not changed much since the inspection on 8/15/03. The burn pile in back has been covered with dirt. A stove, gutters, and other scrap metal are in a pile on the west side of the lot. A neighbor said she now has mice since the house was torn down. (SJR)

Steve left at 10:42 a.m.

State of Illinois
Environmental Protection Agency

SITE SKETCH FORM

Date of Inspection: 8-15-03 Inspector: JB

Site Code: 1418005001 County: Ogle County

Site Name: Gilland, Kenneth Time: 11:25 am - 11:50 am

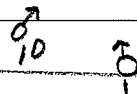
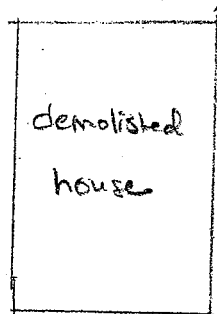
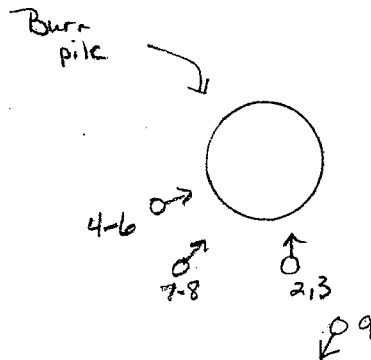

Young Street



North

Not drawn to scale

Numbers denote
photo location &
direction

Digital Photograph Photocopies

Date: 08/15/03
Photos taken by: Joy Bliton

Site: #1418005001-Gilland, Kenneth
County: Ogle

Time: 11:29 a.m.

Direction: N

Photo File Name:
1418005001~081503~001

Comments:
Old house demolished.



Time: 11:32 a.m.

Direction: N

Photo File Name:
1418005001~081503~002

Comments:
Demolition debris from house,
smoldering.



Digital Photograph Photocopies

Date: 08/15/03
Photos taken by: Joy Bliton

Site: #1418005001 - Gilland, Kenneth
County: Ogle

Time: 11:32 p.m.

Direction: N

Photo File Name:
1418005001~081503~003

Comments:
Demolition debris from house
smoldering.



Time: 11:32

Direction: Down

Photo File Name:
1418005001~081503~004

Comments:
Metal, roofing material, wood,
flashing.



1418005001~081503

Digital Photograph Photocopies

Date: 08/15/03
Photos taken by: Joy Bliton

Site: #1418005001-Gilland, Kenneth
County: Ogle

Time: 11:32 a.m.

Direction: Down

Photo File Name:
1418005001~081503~005

Comments:
Construction and demolition
debris.



Time: 11:32 a.m.

Direction: Down

Photo File Name:
1418005001~081503~006

Comments:
Plastic, metal.



1418005001~081503

Digital Photograph Photocopies

Date: 08/15/03
Photos taken by: Joy Bliton

Site: #1418005001 - Gilland, Kenneth
County: Ogle

Time: 11:33 a.m.

Direction: Down

Photo File Name:
1418005001~081503~007

Comments:
Metal, plastic debris.



Time: 11:33

Direction: Down

Photo File Name:
1418005001~081503~008

Comments:
Siding and other demolition
waste.



Digital Photograph Photocopies

Date: 08/15/03
Photos taken by: Joy Bliton

Site: #1418005001-Gilland, Kenneth
County: Ogle

Time: 11:41 a.m.

Direction: SW

Photo File Name:
1418005001~081503~009

Comments:
Demolition waste from house.



Time: 11:50 a.m.

Direction: NW

Photo File Name:
1418005001~081503~010

Comments:
Demolition waste from house.



1418005001~081503

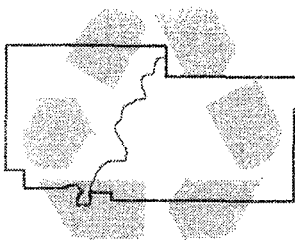

**OGLE COUNTY
SOLID WASTE MANAGEMENT DEPARTMENT**

105 S. Sixth Street
Oregon, IL 61061
815-732-4020
FAX: 815-732-3709
www.oglecounty.org

**State of Illinois, Ogle County
Affidavit**

County of Ogle
Complainant,

v.

Gilland, Kenneth
Respondents.

)
)
) AC No.: 1418005001
)
)
)

Affiant, Joy K. Bliton, being first duly sworn, voluntarily deposes and states as follows:

1. Affiant is a field inspector employed by the County of Ogle and has been so employed at all times pertinent hereto.
2. On, August 15, 2003, between 11:25 and 11:50 a.m. and again on September 24, 2003, between 12:50 and 1:00 p.m., Affiant conducted an inspection of an open dump operated without an Agency permit, located in Ogle County, Illinois and known as Gilland, Kenneth by the Illinois Environmental Protection Agency. Said site has been assigned Site Code No. 1418005001 by the Agency.
3. Affiant inspected said Gilland, Kenneth open dump site by an on-site inspection which included walking and photographing the site.

4. As a result of the activities referred to in Paragraph 3 above, Affiant completed the Inspection Report form attached hereto and made a part hereof, which, to the best of Affiant's knowledge and belief, is an accurate representation of Affiant's observations and factual conclusions with respect to said Gilland, Kenneth open dump site.

Joy K. Bliton, Ogle County

Subscribed and Sworn to Before Me

this 14 Day of Nov., 2003

Notary Public

